

You will
need

Jesus opens the Eyes of a Man born Blind by Duccio

Activity 1

The city of Jerusalem is painted in the background, but it is painted like an Italian city. Jerusalem was the home of Jesus' enemies. For Jesus it was a city of danger. It was the place where he later died.

Write a cinquain poem about the dangers Jesus was facing in going to Jerusalem. Look through the story of the man born blind to get ideas.

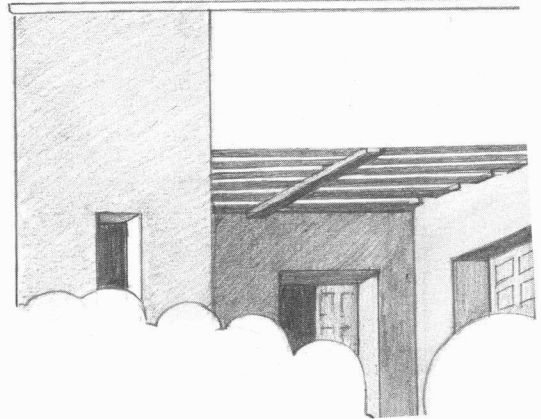

How to Write a Cinquain

- Line 1 should have 2 syllables.
- Line 2 should have 4 syllables.
- Line 3 should have 6 syllables.
- Line 4 should have 8 syllables.
- Line 5 should have 2 syllables.

Example

Punished
By angry men
For doing what is good.
Jerusalem with much danger
Waited.

STEPHANIE SMITH

Activity 2

Go through the story and, using a coloured pencil, shade all the places where people express their feelings about Jesus. Use one colour for positive attitudes and another for negative attitudes.

What is the attitude of Jesus' enemies to his healing of people?
Why do you think they disliked him healing people, particularly on the Sabbath?

If healing people got Jesus into trouble and made enemies, why do you think he carried on?

Christian Belief

Jesus did not run from his enemies, neither did he let their opposition stop him. He deliberately went to Jerusalem and faced them. Christians believe he gave up his life willingly for others. He was not forced into it.